

Wire forming is fun...

just follow these
easy instructions

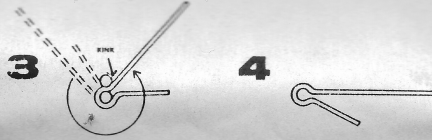
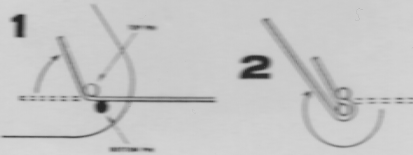

TYPE "B" LOOP

1. Place wire shaft between pins with short end pointed to the left. Bend short end away from you to form right angle. Leave at least $\frac{3}{8}$ " between short end and pin.
2. Bend long end around bottom pin in clockwise manner until it stops at top pin. Don't be concerned when wire springs back, this is normal.
3. Leave wire loop around bottom pin and swing back to right until long end hits top pin. Apply pressure to place kink in long end.
4. Finished loop should look like illustration No. 4. **NOTE:** This is the type of loop which should be used on all spinners where a coil spring fastener is desired for easy changing of hooks.

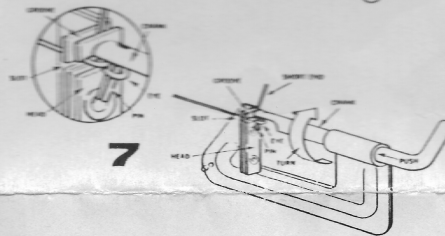

TYPE "A" EYE

1. Place wire shaft between pins with short end pointed to right. Bend long end around bottom pin in counter-clockwise direction a full 360° to form eye. See illustration No. 5.
2. Remove wire shaft, turn it over and place eye over bottom pin so that short end points to the left. Apply pressure to long end against top pin to make kink in shaft. The short end should be at slightly less than a 90° angle to the long end when you finish. See illustration No. 6.
3. Place eye of shaft over pin on crank with short end down and long end through slot in head. Turn crank clockwise slowly so that short end of shaft slides into groove on head. See illustration No. 7.
4. With short end engaged in groove, push crank toward head and turn clockwise at the same time. Continue turning crank until short end of wire is completely wrapped around shaft. You will hear a "click" when this occurs.
5. Remove shaft from head. It should look like illustration No. 8.

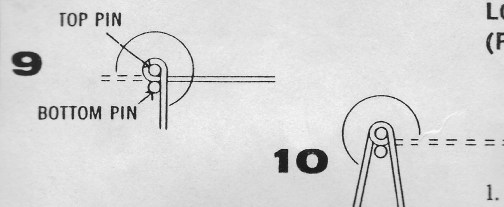

LOOPS IN SHAFTS (For Jig Spinners, etc.)

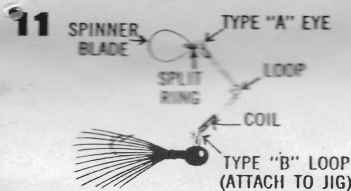

1. Place center of wire shaft between pins. Bend left end in clockwise direction around top pin until shaft hits bottom pin.
2. Keep pressure on bent portion of shaft. Bend right end in counter-clockwise direction around top pin until shaft hits bottom pin. Remove shaft from pins and adjust to form right angle.

NOTE: If you desire to make a Jig Spinner, (FIG. 11) assemble coil spring at one end and make type "B" loop. Make type "A" eye at other end and assemble spinner blade to eye with split ring.